

# SIMONS ADDITION

KNOW ALL MEN BY THESE PRESENTS: That Gerald A. Simons and Rita C. Simons, husband and wife, owners and proprietors, and Home Federal Savings and Loan Association of Minneapolis, a United States corporation, mortgagee, of the following described land, situate in the County of Hennepin, State of Minnesota, to wit:  
Lot 7, Block 1, GLEN WILDING, Hennepin County, Minnesota, according to the recorded plat thereof on file or of record in the office of the Registrar of Titles, in and for said Hennepin County.

Have caused the same to be surveyed and platted as SIMONS ADDITION and do hereby donate and dedicate to the public, for public use forever, the drainage and utility easements as shown on said plat.

In witness whereof Gerald A. Simons and Rita C. Simons, husband and wife, have caused these presents to be signed this 21 day of FEBRUARY, 1978.

And in witness whereof Home Federal Saving and Loan Association of Minneapolis, a United States corporation, has caused these presents to be signed by its proper officers and its corporate seal to be hereunto affixed this 23 day of FEBRUARY, 1978.

SIGNED:

Gerald A. Simons Gerald A. Simons

Rita C. Simons Rita C. Simons

Home Federal Savings and Loan Association of Minneapolis

Virginia Taraldson its Vice President

Marjorie E. Norton its Asst. Vice President

STATE OF MINNESOTA:

COUNTY OF Hennepin

The foregoing instrument was acknowledged before me this 21 day of February, 1978, by Gerald A. Simons and Rita C. Simons, husband and wife.

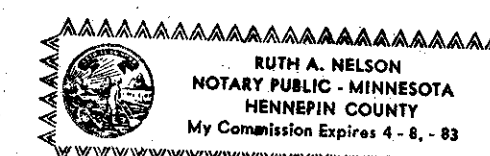

Ruth A. Nelson  
Notary Public, Hennepin County, Minnesota  
My Commission Expires 4-8-83

STATE OF MINNESOTA

COUNTY OF HENNEPIN

The foregoing instrument was acknowledged before me this 23 day of February, 1978, by Virginia Taraldson its Vice President and

Marjorie E. Norton its Asst. Vice President of said Home Federal Savings and Loan Association of Minneapolis, a United States corporation, on behalf of said corporation.

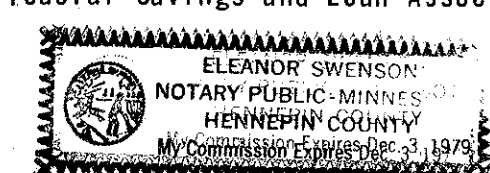

Eleanor Swenson  
Notary Public, \_\_\_\_\_ County, Minnesota  
My Commission Expires \_\_\_\_\_

I hereby certify that I have surveyed and platted the property described on this plat as SIMONS ADDITION; that this plat is a correct representation of said survey; that all distances are correctly shown on said plat in feet and hundredths of a foot; that all monuments have been correctly placed in the ground as shown on said plat; that the outside boundary lines are correctly designated; and that there are no wetlands or public highways to be designated on said plat.

Harry S. Johnson  
Land Surveyor  
Minnesota Registration No. 5065

STATE OF MINNESOTA

COUNTY OF HENNEPIN

The foregoing instrument was acknowledged before me this 16th day of February, 1978, by Harry S. Johnson, Land Surveyor

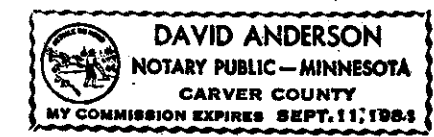

David Anderson  
Notary Public, Carver County, Minnesota  
My Commission Expires Sept. 11, 1984

BLOOMINGTON, MINNESOTA

This plat of SIMONS ADDITION was approved and accepted by the City Council of Bloomington, Minnesota, at a regular meeting thereof held this \_\_\_\_\_ day of \_\_\_\_\_, 1978.

CITY COUNCIL OF BLOOMINGTON, MINNESOTA

BY: \_\_\_\_\_ MAYOR

BY: \_\_\_\_\_ MANAGER

FINANCE DIVISION, Hennepin County, Minnesota

I hereby certify that there are no delinquent taxes for all years prior to 1978 for land described on this plat, Dated this \_\_\_\_\_ day of \_\_\_\_\_, 1978.

Vernon T. Hoppe, Director

BY: \_\_\_\_\_ Tax Clerk

HENNEPIN COUNTY SURVEYOR

Pursuant to Chapter 810 Minnesota Laws of 1969, this plat has been approved this \_\_\_\_\_ day of \_\_\_\_\_, 1978.

BY: Alver R. Freeman, Hennepin County Surveyor

REGISTRAR OF TITLES, Hennepin County, Minnesota

I hereby certify that the within plat of SIMONS ADDITION was filed for record in this office this \_\_\_\_\_ day of \_\_\_\_\_, 1978, at \_\_\_\_\_ o'clock \_\_\_\_\_ M. and that the two copies were compared with the official plat and were found to be true and correct copies thereof.

Wayne A. Johnson, Registrar of titles

BY: \_\_\_\_\_ Deputy

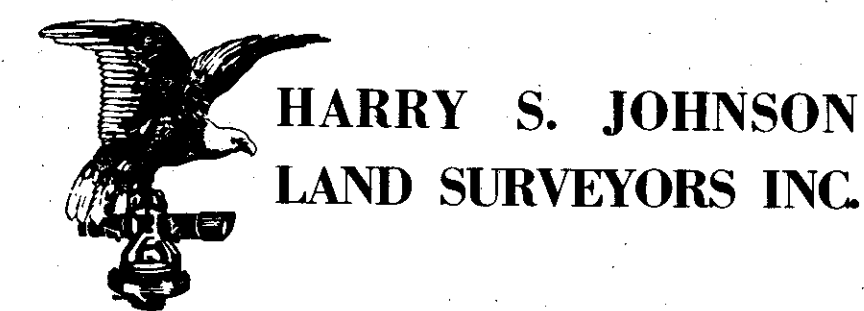

THIS SPACE RESERVED FOR BINDING

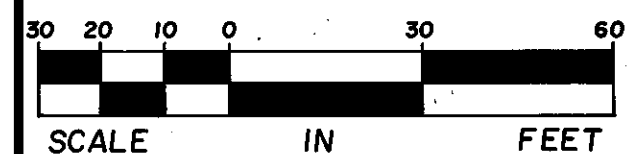
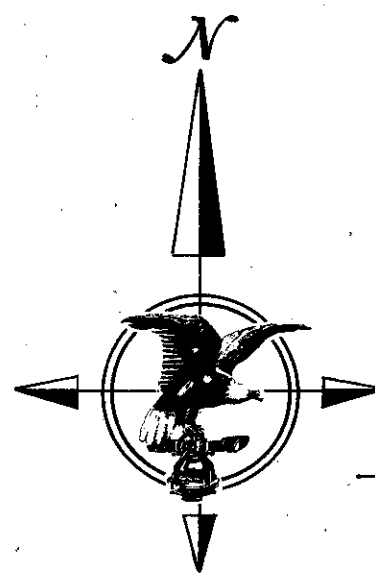

SCALE IN FEET  
o Denotes iron monument  
Bearings shown are based on an assumed datum

