

R-6

38666

Original

# REDWOOD

## HENNEPIN COUNTY

### MINN

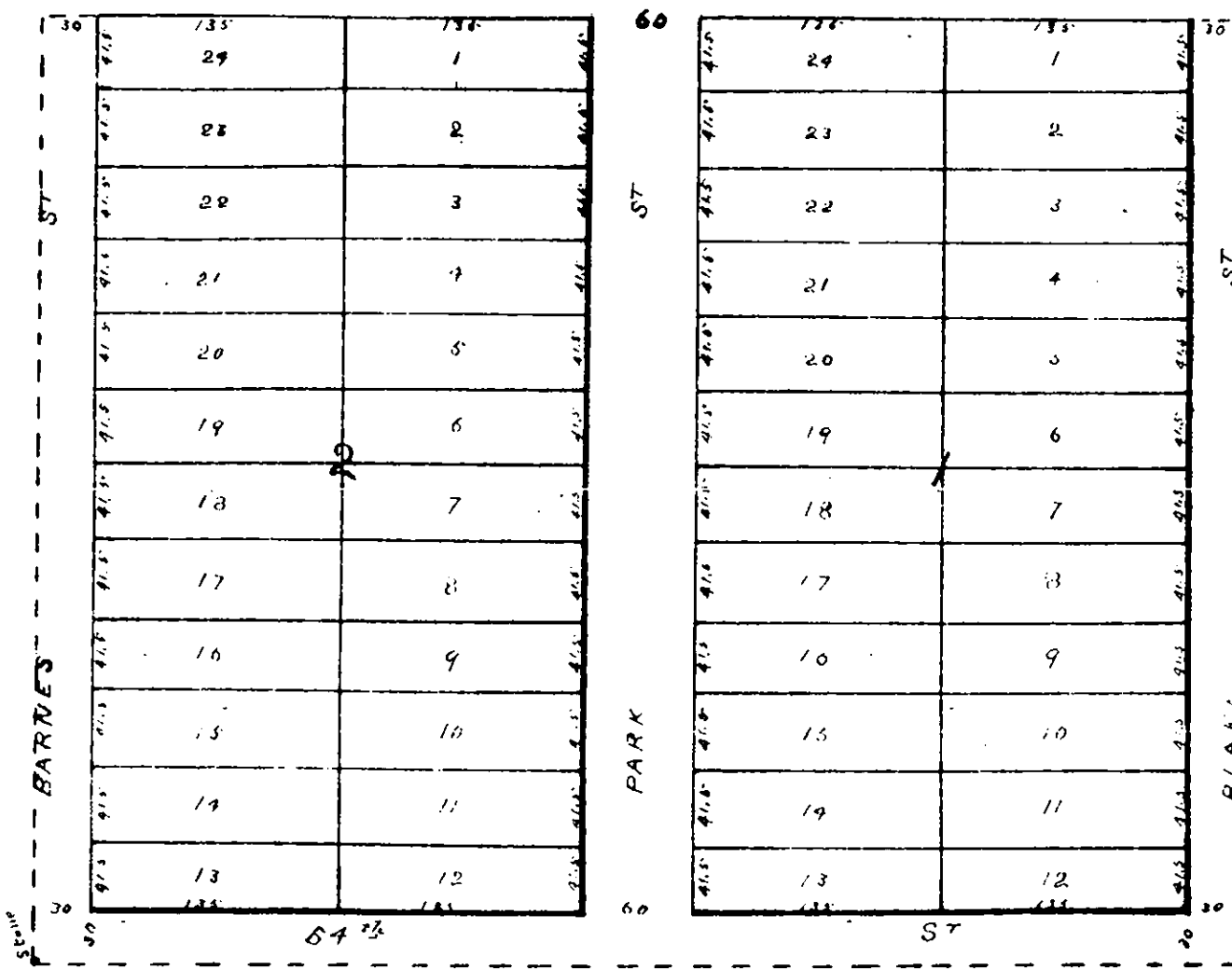

OFFICE OF REGISTER OF DEEDS,  
HENNEPIN COUNTY, MINNESOTA.

I Herby Certify, That the within Plat of .....  
*Redwood* ..... was filed in the office for record this  
 1<sup>st</sup> day of *February* ..... A. D. 1888 at 1<sup>10</sup> o'clock *P.M.*  
 and was duly Recorded in Book *19* of this office on the *14*  
 day of *February* .....  
 By *W. W. Lamm* Deputy.  
*James Peterson*  
 Register of Deeds.

I hereby certify that the within plat is a true and correct plat of a subdivision of the South East 1/4 of Section 29, Township 116 North, Range 21, bounded and described as follows, beginning at the South West corner of the South West 1/4 of the South East 1/4 of Section 29, Township 116 North, Range 21 and running North 528 ft. thence East 660 ft. thence South 528 ft. thence East 660 ft. to the beginning. That the lots and streets in said subdivision are as indicated by the figures upon the above drawing and that I have caused a stone to be placed on the South West corner of said subdivision.

*S. W. Simonds*  
*F. W. Conkey*  
 State of Minnesota  
 County of Hennepin

Before me a Notary Public in and for said County on the 30<sup>th</sup> day of January A. D. 1888 personal came to me *A. B. Haas* and *Maria A. Haas* as the person described and who executed the above certificate and acknowledges the signing of the same as his free act and deed.

*S. W. Simonds*  
 Notary Public  
 Hennepin County

and his wife *Maria A. Haas* January 30<sup>th</sup> 1888  
*A. B. Haas* of Minneapolis Hennepin County Minnesota  
 husband and executor of an estate do hereby  
 certify that we have caused this same to be surveyed and platted as indicated  
 by the above drawing and have caused the same to be recorded and that we do  
 hereby indicate to the public forever all lands included on the above drawing  
 as shown to  
*A. B. Haas*  
*Maria A. Haas*

*S. W. Simonds*  
*Bruce Spring*  
 State of Minnesota  
 County of Hennepin  
 Before me a Notary Public in and for said County on the 30<sup>th</sup> day  
 of January A. D. 1888 personal came to me *A. B. Haas* and his wife  
*Maria A. Haas* as the persons described in and who  
 executed the above certificate and acknowledges the signing of the  
 same as their free act and deed.

*S. W. Simonds*  
 Notary Public  
 Hennepin County

Taxes paid and transferred  
 for taxation Feb'y 1<sup>st</sup> 1888  
*L. A. Condit*  
 County Auditor

212